

PTS

Planet Threaded Ram along with safety Lock Nut Spring Return – Single Acting

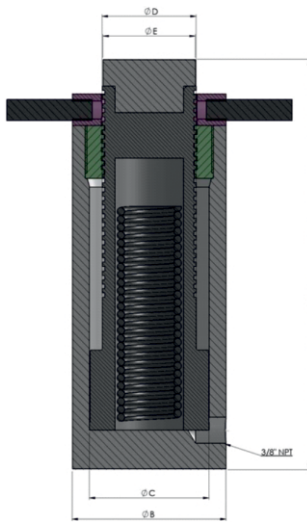

APPLICATION

These jacks are ideally used for Lifting of Girders, Building Foundations, Handling of Heavy Duty Machineries, Steel Fabrication, Ship Building, Testing of Concrete Structures, etc.

FEATURES /ADVANTAGES

- Cylinder is honed to a surface finish of 0.5 microns.
- Load return. Single acting, Threaded Ram, Safety Lock Nut. Alloy steel heat treated.
- At the bottom holes are provided to Fix.
- High pressure seals for better life. Ram wiper protects entering dirt and foreign material into the cylinder which extends cylinder life.
- Long lifting handles are provided for easy lifting at site.
- Connection Port 3/8" NPT.



PTS Series - P: Planet, **T:** Threaded Rod, **S:** Single Acting Spring Return, **10:** Capacity - ton, **150:** Stroke - mm

Model	Cap in (ton)	Cap. in (kN)	Stroke in (mm)	"A" Close Height	Effective Area in (cm ²)	Oil Cap in (cc)	"B" Cyl. OD	"C" Cyl. Bore ID	"D" Rod dia.	"E" Saddle dia.	wt. App in (kg)
PTS 10 - 150	10	111	150	245	15.9	239	60	45	40	35	4.5
PTS 15 - 150	15	167	150	250	23.8	356	70	55	45	40	6.5
PTS 20 - 150	20	218	150	260	31.2	468	80	63	55	50	9
PTS 25 - 150	25	270	150	270	38.5	577	90	70	55	50	11.5
PTS 30 - 150	30	309	150	275	44.2	663	100	75	60	55	15
PTS 50 - 150	50	550	150	290	78.5	1178	130	100	80	75	27
PTS 75 - 150	75	792	150	295	113.1	1696	155	120	95	90	39
PTS 100 - 150	100	1077	150	305	153.9	2309	180	140	110	105	54
PTS 150 - 150	150	1589	150	325	227.0	3405	220	170	140	135	87.5
PTS 200 - 150	200	2199	150	340	314.2	4712	255	200	160	155	122
PTS 250 - 150	250	2661	150	350	380.1	5702	280	220	180	175	154
PTS 300 - 150	300	3167	150	370	452.4	6786	310	240	200	195	202.0
PTS 400 - 150	400	4008	150	405	572.6	8588	355	270	220	215	283
PTS 500 - 150	500	4948	150	450	706.86	1060.29	400	300	250	245	390

- Specifications are subject to change due to continual improvement.
- Higher capacity and customized solution on request.
- Capacity and Stroke specified are maximum safe limits. Use at 80% of rating as safe practice.

